

Concrete & ICF Technology. A Better Way to Build. Residential & Commercial.

Extremely Energy Efficient

Mold Resistant

Affordable

Incredibly Quiet

Build Green

Fire Resistant

Durable

Low Maintenance

Warm in the Winter

Cool in the Summer

Flexible to Any Design

Higher Resale Value



CEMSTONE
CONCRETE SOLUTIONS

Insulating Concrete Form (ICF) technology

is simply today's best method of building extremely durable and energy efficient walls for your home or commercial building. The process combines high density, lightweight foam blocks (or forms) that are filled with a special concrete mix design. The end result is a high performance wall system that makes wood look good... but only if you're building kitchen cabinets, not walls.

Reward forms are made of expanded polystyrene (EPS), a material similar to that in styrofoam ice chests you can buy at the grocery store. The forms are made up of two panels of EPS held together by plastic ties. The ties are embedded into the foam to hold the form together. The embedded ends of the ties flatten out to form fastening surfaces recessed within the foam to allow for any type of exterior or interior finish. Since the ties run the full height of the forms, a Reward wall contains continuous furring strips, foundation to eave line.

To build Reward walls, simply stack the forms to meet any wall dimension, install vertical and horizontal rebar as you stack the forms, brace and align the forms, and pump the center cavity with concrete. You now have a completed wall, insulated and ready to finish any way you choose.

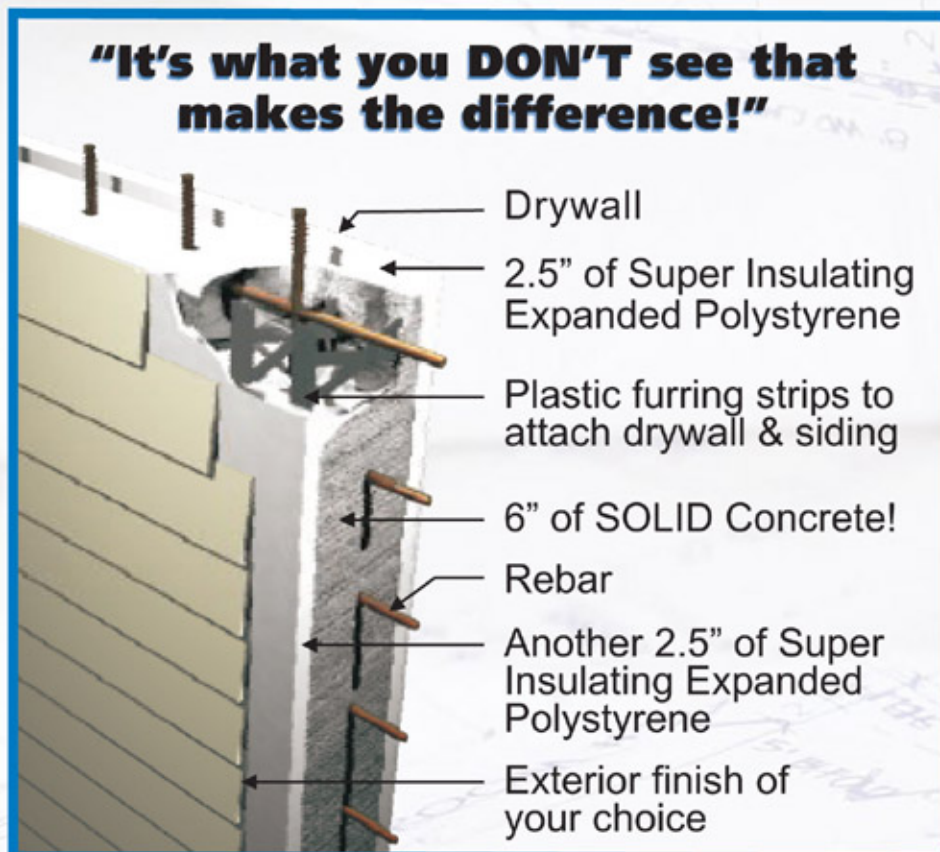

Beauty & Flexibility

A finished ICF home looks just like any other home. Just because it's concrete, doesn't mean it is gray and cold. ICF homes can be completed with any interior and exterior finish you prefer. The beauty of today's concrete home means you get the benefits of concrete (strength, durability, energy efficiency, etc.) without your home looking "concrete", because the concrete is in the middle of the wall structure, not on the outside. The concrete is surrounded by polystyrene, then sandwiched between an otherwise normal looking shell.

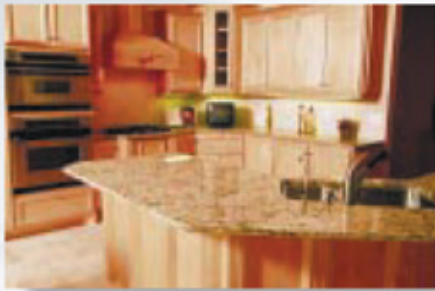

Architects love the design flexibility. Unique curves and angles can be achieved by the combination of concrete's fluidity when being poured, and its incredible strength once cured.

Engineers and Inspectors love the ultimate strength and stability that comes with a reinforced wall system.

Builders and Contractors love the ease of construction, the ability to keep working in any weather conditions and the opportunity to provide a solid, energy efficient, low maintenance home for their customers.



Healthy Indoor Air

Homes built with ICF technology allow VERY little air escape or infiltration and they maintain much more even temperatures throughout the day. The solid concrete wall acts as a continuous barrier against air infiltration so the interior environment has a substantially reduced level of airborne dusts and allergens when a fresh air exchanger is used. Your family will breathe healthier air every day.

Mold Resistant

Here in the upper Midwest, we receive an average of 28" of rainfall each year and an additional 40" of snowfall. This invites dry rot, mildew and mold infestation, which can be harmful to your health. ICF's structural integrity is virtually impervious to the type of damage associated with our moist climate. No timber is immune to attack from termites and carpenter ants. Let's just put it this way: Bugs don't eat concrete!

Noise Reduction

As we build closer to freeways, airports and each other; peace and quiet within our homes has become an important part of its overall comfort and a prominent selling feature. ICF walls provide a typical Sound Transmission Class (STC) rating of more than 50. The STC rating for the outside walls of the typical wood framed house range

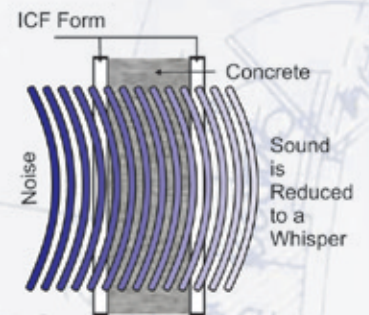

between 33 and 45. An ICF wall rated at 50 compared to a wood stud wall rated at 40, equates to approximately a 50% noise reduction because STC ratings are based on logarithmic calculations. Making your ICF home a safe, quiet and very comfortable place to be.



